



# **Specification**

## **For OVP-H6X video controller**

**Version: V1.0    Date: 2022.3.3**

## **Description**

OVP-H6X four-screen two-in-one controller is a high-end video processing equipment developed and produced by our company for LED large-screen display, performance and rental, conference room, studio and other markets. This product adopts 4K image processing technology specially designed for small-pitch LED displays, which can effectively eliminate the edge jaggedness introduced by the image enlargement, and reduce the out-of-focus blur after the image is enlarged. OVP-H6X can receive ultra-high-definition 4096x2160@60Hz image input and display four-window images at the same time, which can meet the application requirements of super large LED display, hybrid LED display, special-shaped screen and so on. OVP-H6X also integrates 12-channel Gigabit Ethernet port output, which combines a conventional video processor and a sending card into one, which not only improves reliability, but also brings great convenience to remote maintenance of the LED display.

## **Features**

- Maximum resolution is 7.86million pixels, the horizontal maximum 16000 pixels, vertical maximum 16000 pixels;
- Cluster with 12 channels of Gigabit network output
- Fast seamless switch between all input signage and output mode
- With 7 channels HD digital and analog input interface;
- With dedicated DVI monitoring output interface, support local screen output monitoring;
- Support 5 channel digital input port DVI\HDMI\DP custom input resolution settings;
- Support hot backup of input signal source;
- 16 user modes can be stored for users to quickly call;
- With fast switching mode, the pre-monitoring screen can be seamlessly switched to the large LED screen for broadcast instantly;
- With "intelligent navigation" setting function, convenient for users to quickly set;
- The device can be controlled through LCD panel button, LAN,, USB interface or WIFI,RS232 device.

# Instruction

## Front panel

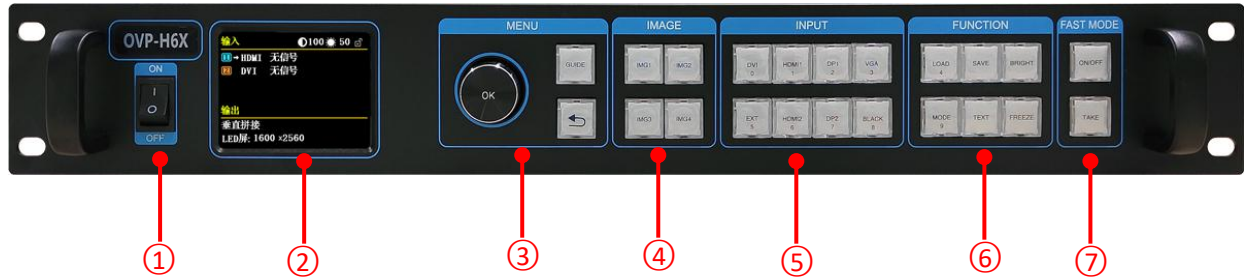

Interface	
1	Power switch
2	2.8" full color LCD panel 320×240)
3	<p>Operation via LCD panel system</p> <p><b>MENU area</b>            MENU area Short press the [OK] button: enter into the main menu or input confirmation            [GUIDE] button: fast turn to the "smart guide" mode            [↶] means turn out of the current operation</p>
4	<p><b>IMAGE area</b>            [IMG1]- [IMG4]: select the window1-4 ,led light indicate the selected window</p>
5	<p><b>INPUT AREA</b>            [DVI] ~ [USB] 8 buttons, 8 nos of input port button,mark:press "BLACK" then the LED indicate light is on ,then output the black screen status</p>
6	<p><b>FUNCTION AREA</b>            [BRIGHT]: fast switch the brightness menu            [FREEZE]: image freeze            [LOAD]: fast turn on the user mode            [SAVE]: fast switch the user mode save menu            [MODE] : fast switch to the fix mode menu            [TEXT]: keep the function button</p>
7	<p><b>FAST-MODE AREA</b>            [ON/OFF] fast mode to open/close fast button            [TAKE] switch the current signal and the alternative signal</p>

**BACK PANEL**



Video output	
LED1~LED12	12 pcs Gigabit network output,Send via network cable to LED screen
MONITOR	Synchronous multi-windows monitor DIV output port, connect with LCD display

Video input source	
EXT	extend to DVI or SDI or screen cast, ( HDMI standard match)
DVI	DVI port
HDMI1	HDMI port 1
HDMI2	HDMI port 2
DP1	DP port 1
DP2	DP port 2
VGA	VGA port

Audio input/output port	
HDMI audio	HDMI video input port built-in
DP audio	DP video input port built-in
AUDIO_IN	Analog audio input port
AUDIO_OUT	Analog audio output port

Control interface	
LAN	LAN port
COM	USB port
WIFI	WIFI control
RS232	RS232C serial control DB9 port

Power	
Input voltage	100-240V~50/60Hz

## Technical parameters

Image input port	
EXT×1	Expansion input port, standard HDMI, DVI interface, SDI interface, wireless same-screen module can be flexibly selected according to customer needs
DVI×1	VESA Standard: 1920×1080@60Hzto down, support 3840×2160@30Hz
HDMI×2	VESA Standard: 1920×1080@60Hzto down, HDMI 1.4
VGA×1	VESA Standard: UXGA@75Hzto down
DP×2	VESA Standard: 3840×2160@60Hzto down, DP1.2

Image output port	
DVI×1	1024*768@60Hz
NET×12	12 Gigabit Ethernet port output, connected to the LED display through a network cable, directly connected to the receiving card; The maximum load is 7.86 million pixels, the width is less than or equal to 16000, and the height is less than or equal to 3840;

Audio input/output port	
Audio input×1	3.5mm audio port
Audio output ×1	3.5mm audio port

Details	
voltage	100-240V~50/60Hz
power	≤50W
Working Temp	-30°C~70°C
Working humidity	15%~85%
Operate	LCD panel、 button on panel、 LedshowTV、 OVP Builder software、 APP
Package size	482.6mm×300mm×66.6mm
Case	1.5U
Weight	≤5Kg

Dimension

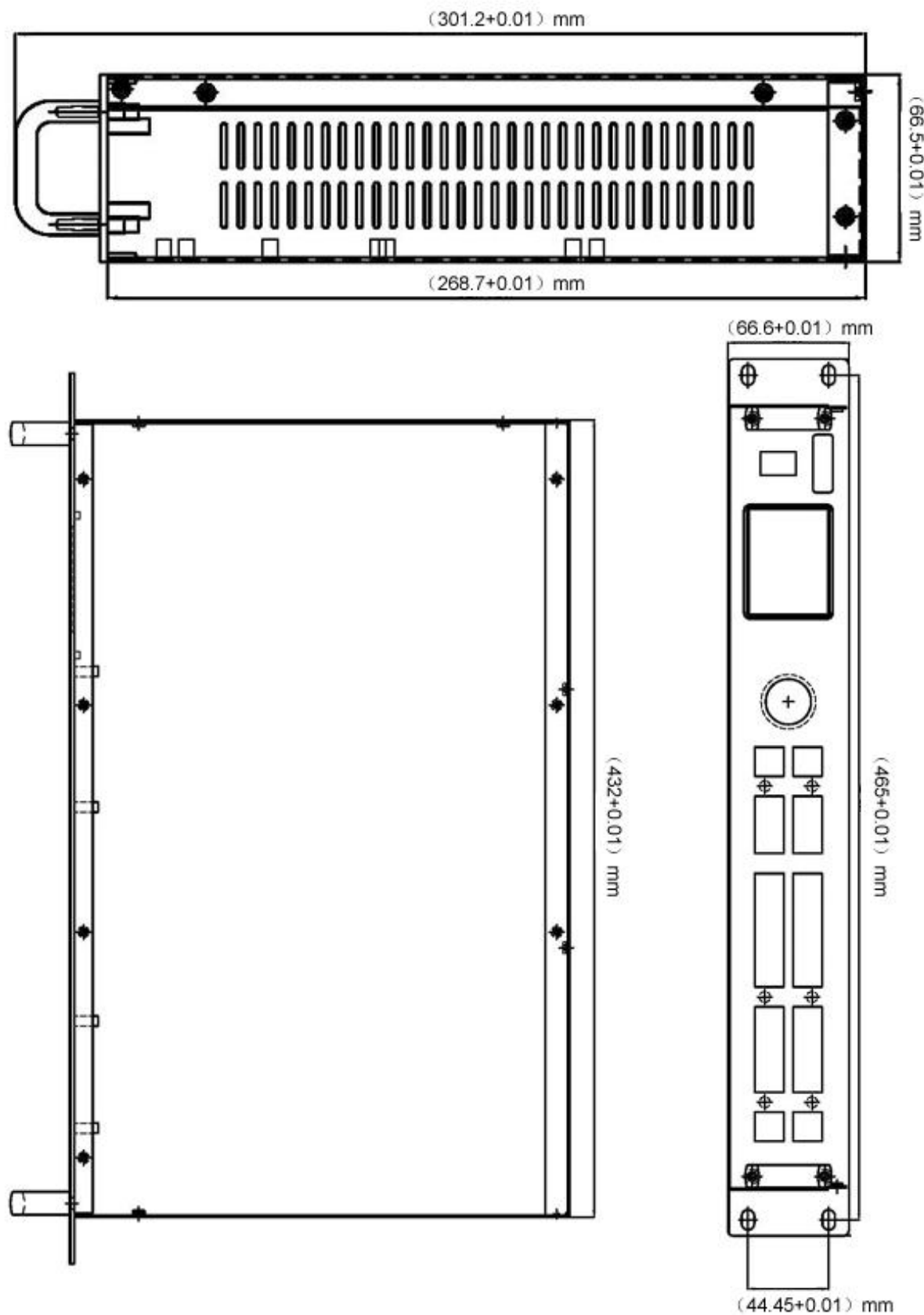

**Accessory**

Name	Qty
3Pin power cable 1.5M	1
WIFI antenna	1
USB-A-B cable 1.5M	1
HDMI2.0 cable 1.5M	2
HDMI-DVI connector	1
CAT-6 NET cable 1.5M	1

## **CONTACT US**

### **Shanghai ONBON Technology Co.,Ltd (Headquarters)**

Address: 7 Floor, Tower 88, 1199#, North Qinzhou Road, Xuhui District, Shanghai City,

China

Tel Phone: 086-21-64955136

Fax: 086-21-64955136

Website: [www.onbonbx.com](http://www.onbonbx.com)

### **ONBON (Jiangsu) Optoelectronic Industrial Co.,LTD**

Address: 1299#, Fuchun Jiang Road, Kunshan City, Jiangsu Province, China

### **Sales Contacts**

Tel: 0086-15921814956 0086-15800379719

Email: [onbon@onbonbx.com](mailto:onbon@onbonbx.com)

### **Second Development**

Tel: 0512-66589212

Email: [dev@onbonbx.com](mailto:dev@onbonbx.com)

### **iLEDCloud**

Website: <http://www.iledcloud.com/>